

## SOLAR LED MOTION LIGHT Quick Start Guide

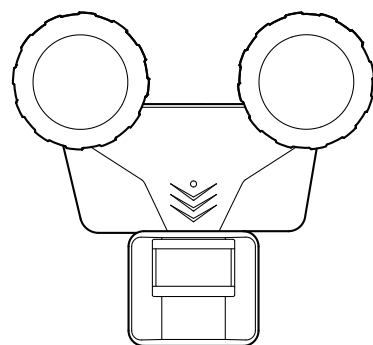

Peel this guide off the package and keep for convenient reference.

Scan this QR code to conveniently download the Novolink App.



Works with iPhone iOS 6.0 or later, or Android 4.3 or later. Smart device requires Bluetooth 4.0 or later.



Select and Set the Motion Light



Motion Light DSB1



Motion Light DSW1



Use the QR Code Scanner in the Novolink App



Rename your Motion Light and customize the picture.

The App will automatically connect to your Motion Light via Bluetooth

## What's in the Box



Solar LED Motion Light

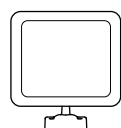

Solar Panel



(6) Phillips Screw



(6) Plugs

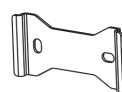

Quick Clip Mounting Bracket

## What You'll Need



Power Drill



Level



Safety Glasses



Phillips Screwdriver



Ladder



Pencil

## Installation

(We recommend reviewing the comprehensive instruction manual before attempting installation.)

1. Position Solar Panel on desired wall and mark 4 holes for pre-drilling.

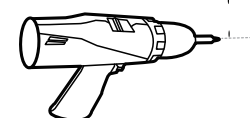
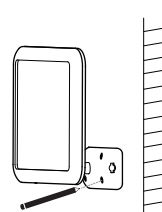

2. Pre-drill holes and attach Solar Panel to wall.

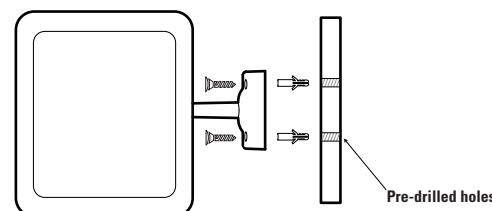

3. Position Quick Clip on desired wall and mark 2 holes for pre-drilling. Install the Quick Clip onto the wall, and mount the Motion Light using the light hook on the back of the unit.

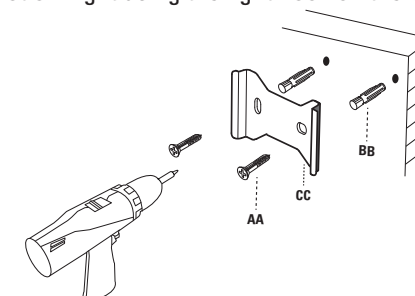

4. Connect the Solar Panel to the Motion Light. Allow the unit to charge for 3 days. Charge the unit in the OFF position.

